

DESK MOUNT ROTARY PANEL RF REMOTE CONTROLLER

Model number: **RK1** **RK3**

Elite Series (Mono Colour & RGB)

Features

- Apply to single color, or RGB LED controller.
- knob to change RGB color, color temperature or brightness, support long press or twice click operation..
- Each remote can match one or more receiver..
- CR2032 battery powered.
- Desk mount, removeable anywhere easily.



RK1

1 Zone Dimming



RK3

1 Zone RGB

CE RoHS  LVD RED

Technical Parameters

Input and Output

Output signal	RF(2.4GHz)
Working voltage	3VDC(CR2032)
Working current	<5mA
Standby current	<10μA
Standby time	1 year
Remote distance	30m(Barrier-free)

Safety and EMC

EMC standard (EMC)	ETSI EN 301 489-1 V2.2.3 ETSI EN 301 489-17 V3.2.4
Safety standard (LVD)	EN 62368-1:2020+A11:2020
Radio Equipment (RED)	ETSI EN 300 328 V2.2.2
Certification	CE,EMC,LVD,RED

Environment

Operation temperature	Ta: -30 °C ~ +55 °C
IP Rating	IP20

Weight

Net weight (g)	61
Gross weight (g)	118

Warranty

5 years

Mechanical Structures & Installations

All sizes in mm

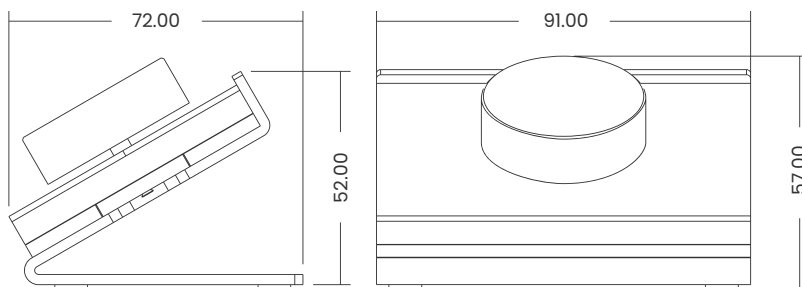

Replace Battery

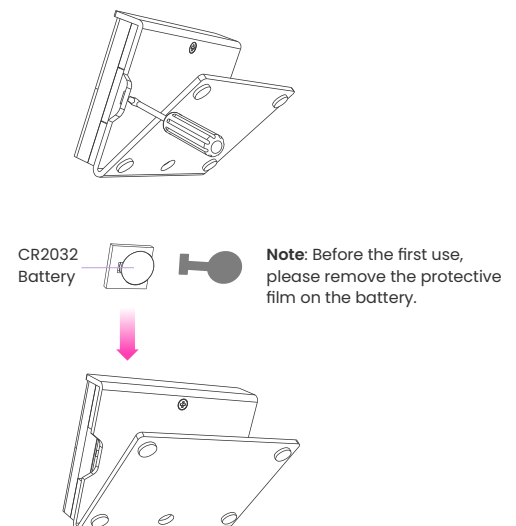

Match Remote control

End user can choose the suitable match/delete ways. Two options are offered for selection:

1. Use the controller's Match key

To Match:

Short press match key, immediately push the knob.
The LED indicator fast flash a few times means match is successful.

To Delete:

Press and hold match key for 5s to delete all match.
The LED indicator fast flash a few times means all matched remotes were deleted.

2. Use Power Restart

To Match:

Switch off the power, then switch on power, repeat again.
Immediately push the knob 3 times. The light blinks 3 times means match is successful.

To Delete:

Switch off the power, then switch on power, repeat again.
Immediately push the knob 5 times. The light blinks 5 times means all matched remotes were deleted.

RK1

Single color dimming remote



Push

After turn on light

Turn on or off light.

Rotate

Long push(1-6s)

Rotate knob to adjust brightness(2.5 turns, 50 levels).

Continuous 256 levels brightness adjustment.

RK3

RGB remote



Push

After turn on light

Turn on or off light.

Rotate

Push twice

Long push(1-6s)

Rotate knob to change RGB color (3 turns, 60 colors or brightness (2.5 turns, 50 levels).Continuous 256 levels brightness adjustment.

Switch between RGB color or brightness adjustment.

Continuous 256 levels brightness adjustment.

Safety Information

1. Read all instructions carefully before you begin this installation.
2. When installing battery, pay attention to the battery positive and negative polarity.
3. A long time without the remote control, remove the battery.
4. When remote distance becomes smaller and insensitive, replace the battery.
5. If no response from the receiver, please re-match the remote.
6. Gently handle remote, beware of falling.
7. For indoor and dry location use only.