

## In the Box:

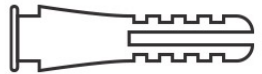

Screws



Wall Plugs



Spacer (A)



Spacer (B)

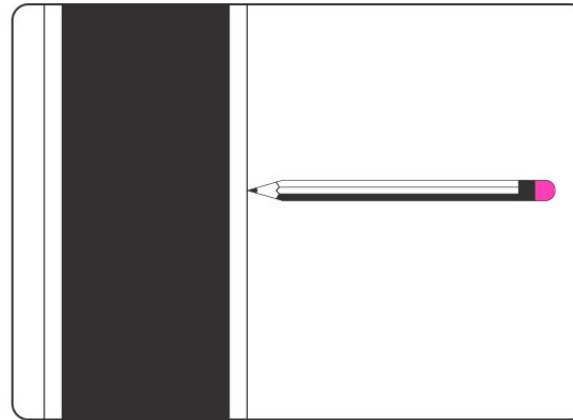

**1** | Using a pencil and your sign as a stencil, mark the drill holes

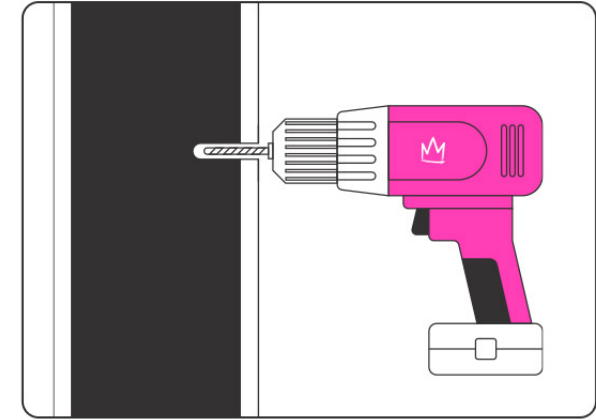

**2** | Drill 0.9cm into the marked holes on the wall

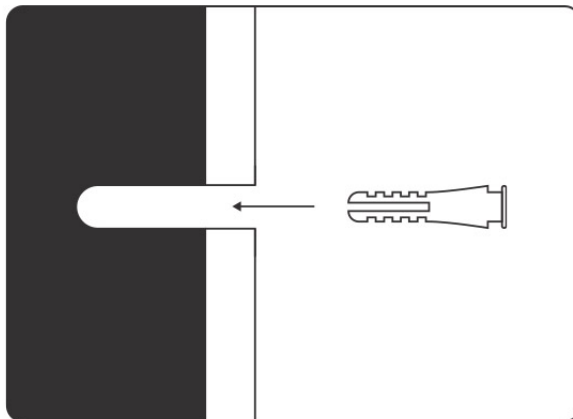

**3** | Place wall plugs into the holes in the wall

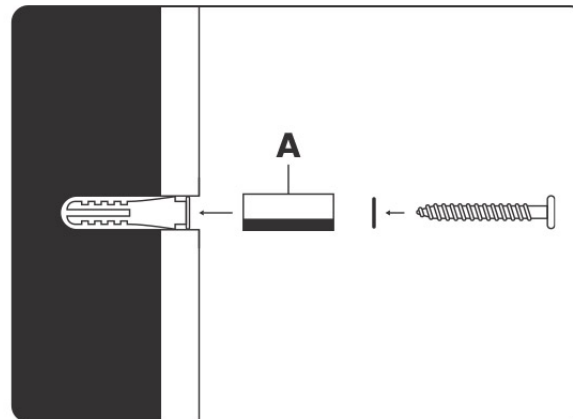

**4** | Place wall screws into the spacers and drill into wall

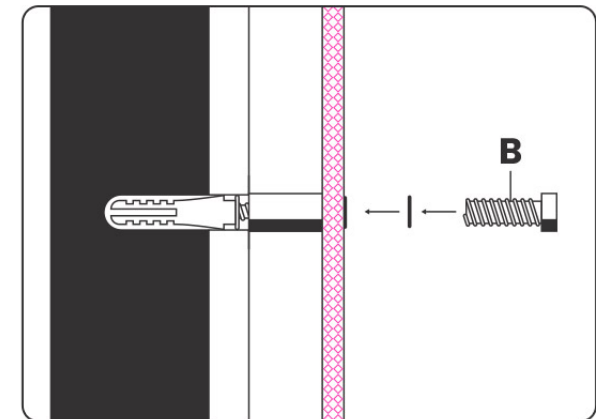

**5** | Position the sign, and tightly screw in the spacer screws